

This drawing is copyright of Leslie Burgher Chartered Architect and may not be reproduced without permission.

This drawing is not to be scaled.

All dimensions to be confirmed on site before work commences.

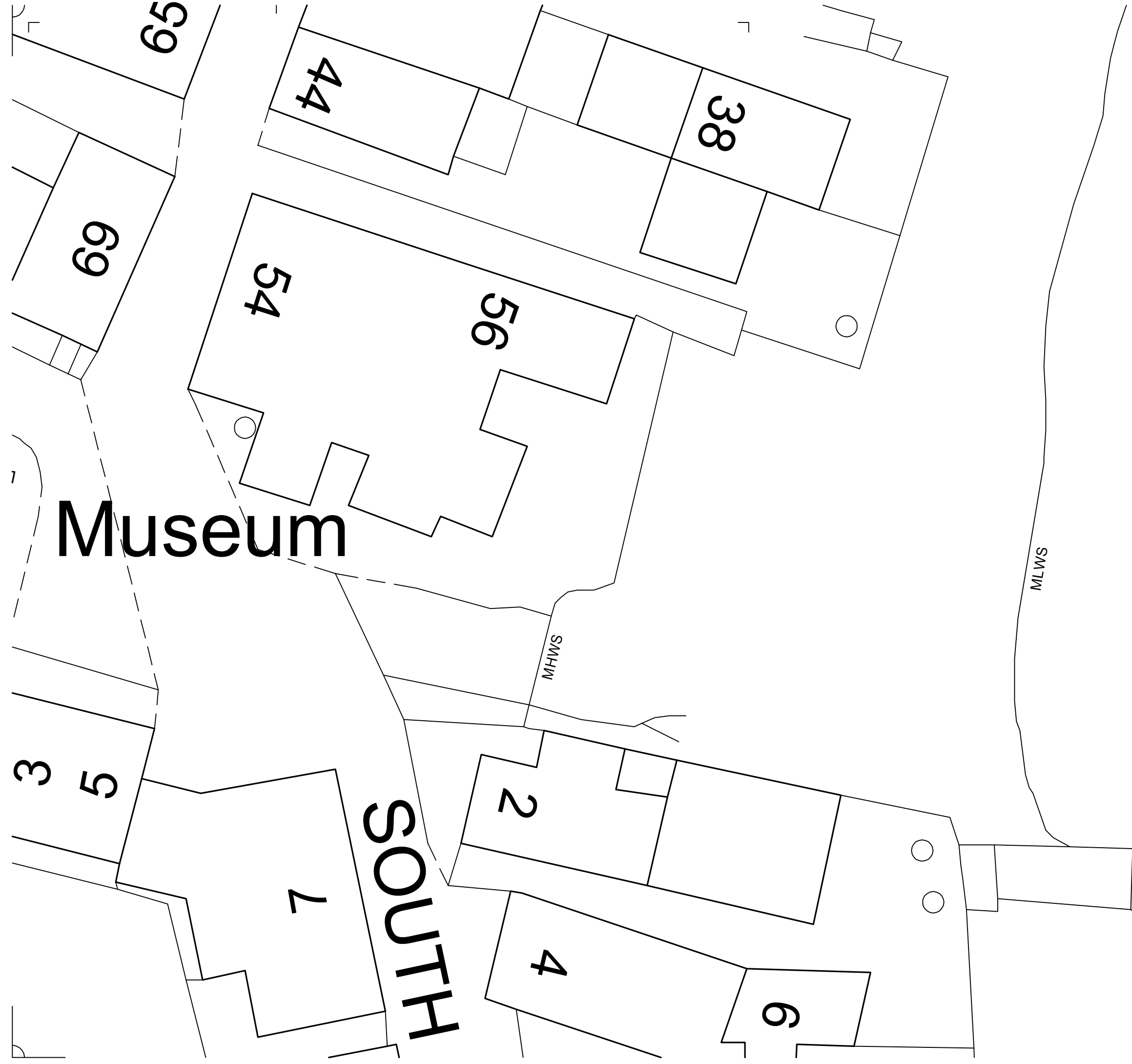

Prelim

Amendments

Client:	ONHS
Project:	Stromness Museum
Drawing:	Site Plan
Scale:	A3
Drawn:	jlb

Leslie Burgher
Chartered Architect

Roebank High Street Kirkwall Orkney KW15 1AZ
t: 01856 871375 e: leslie@leslieburgher.co.uk



Ref:	No:	Amd:
1814	A 002	-